

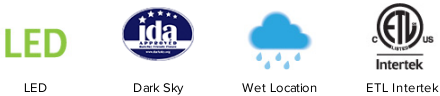

Baytree Lane - LED Light Wall Mount

Item #:	71169-143C-L
UPC Code:	747396097916
Product Family Name:	Baytree Lane
Finish:	Oil Rubbed Bronze W/Gold Highlights
Category:	WALL MOUNT
Category Type:	
Certification:	3057374
Patents:	
Notes:	



MEASUREMENTS

Width:	11
Length:	
Height:	9.75
Extension:	12.75
Height Adjustable:	NO
Min Overall Height:	
Max Overall Height:	
Slope:	NO
Wire Length:	7"
Chain Length:	
Safety Cable Included:	NO
Net Weight:	1.63
Canopy Width:	
Canopy Height:	
Canopy Length:	
Center to Bottom:	4.88
Backplate Width:	5.0
Backplate Height:	1.75
Center to Top:	4.88
Power:	

LAMPING

No. of Bulbs:	1
Max Bulb Wattage:	14
Light Type:	LED
Socket:	LED MODULE
Dimmable:	YES
Ballast:	
Rated Life Hours:	30000
Photocell Included:	NO
Bulb/LED Included:	Y
Bulb/LED Included:	YES
Color Temp.:	2700
CRI:	91
Initial Lumens:	893.8
Delivered Lumens:	430.5

GLASS

Description:	ETCHED OPAL GLASS
Material:	GLASS
Part No.:	G71163-L
Quantity:	1
Width:	3.35
Height:	1.57
Length:	3.35

SHIPPING

Carton Width:	12.0
Carton Height:	13.25
Carton Length:	15.25
Carton Weight:	3.89
Carton Cubic Feet:	1.403
Small Package Shippable:	YES
Master Pack Width:	
Master Pack Height:	
Master Pack Length:	
Master Pack Weight:	
Master Cubic Feet:	
Multi-Pack:	
Master Pack:	1

⚠ WARNING: Handling this product can expose you to chemicals including lead, which is known to the State of California to cause cancer and birth defects or other reproductive harm. Wash hands with soap and water after installing, handling, cleaning or otherwise touching this product. For more information go to: www.P65Warnings.ca.gov.

For additional information, please contact Customer Care: 1-800-221-7977. Product depicted on this spec sheet is protected by United States Federal and/or State laws including US Patent, Trademark and/or Copyright and unfair competition laws. Unauthorized reproduction or use carries severe legal penalties.

Rev 01.09.2024 03:18 AM



120V 16 Inch Commercial Grade Vintage Barn Hanging Outdoor Pendant Lighting - AQ-PENST-1443

DESCRIPTION

Voltage: 120V 60Hz AC
Socket Type: UL Certified E26 Medium Base (E105933)
Bulb Type: PAR / BR Reflector / A19
Power Rating: 60w Max
Mounting: Ceiling / Surface
Weight: 4.69 lbs
Size: 16" Diameter X 10" Height X 71" Length



DIMENSIONS

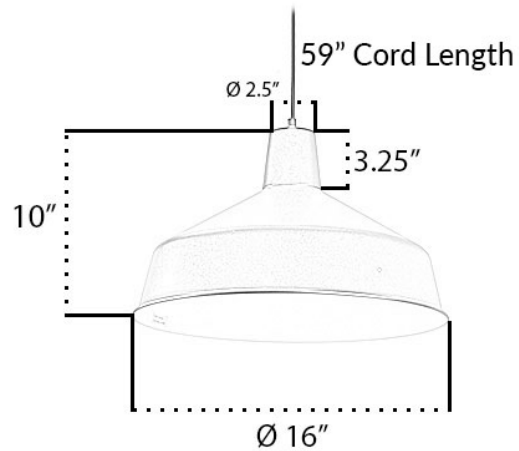

ACCESSORIES

Recessed UL Certified Medium Base Socket



FINISHES



Copper/ Black Cap

ORDERING INFORMATION

AQ-PENST-1443

FINISH

BLK BLACK
RTB RETRO BRONZE
BLU BLUE
R RED
COP COPPER
WH WHITE
RBK RED/BLK CAP
WBK WHITE/BLK CAP
CBK COPPER/BLK CAP

BULB

WWSE 120V 11W DIM LED WARM WHITE SQUAT LIGHT ENGINE
WWED 120V 3.5W VINTAGE EDISON STYLE FILAMENT G25 DIM WARM WHITE
CWA 120V 6W DIM LED COOL WHITE A19

AQ-PENST-1443- _____ - _____

Fixture Type: _____

Job Name: _____

Notes: _____





| **SYNLAWN**®

Installation Guidelines

for Artificial Grass



lowes.synlawn.com

866-268-6100

service@synlawn.com

#45036

Before You Buy

Considerations Before you Buy and Install Artificial Grass

Before you purchase **SYNLawn Artificial Grass** for your project you should carefully examine the area where you would like to install the artificial grass. There are some areas where installing artificial grass may not be appropriate:

- ▶ Areas where there are a large number of trees with exposed roots
- ▶ Areas where an adjoining property owner's lawn is eroding onto your property
- ▶ Areas with poor drainage or areas that lack a natural drainage outlet may require extensive subsurface work before artificial grass can be installed.
- ▶ Artificial grass can melt if it is struck by concentrated refracted light. While this problem is most common in areas that have high daily temperatures, it can occur almost anywhere in the Southern USA. Windows, fences, and other shiny surfaces, especially curved surfaces, can concentrate light and create temperatures over 300 degrees Fahrenheit. SYNLawn and Lowe's will not be responsible for damages caused by refracted light. Painting surfaces or applying films to windows can mitigate refracted light issues.
- ▶ Read the guidelines in its entirety before you begin.

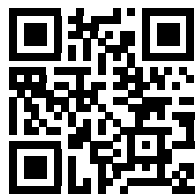

For installations over 200 sq.ft. we strongly recommend using an Installation Professional. Large installations can be very labor-intensive and are not recommended for everyone. Let us do the heavy lifting for you. Visit https://www.lowes.com/l/install/artificial-grass?utm_source=synlawn&utm_medium=lowes&utm_campaign=installation

Measuring The Area



Measuring Wheel

Tape Measure

Marking Paint

Sketchpad or iPad

NOTE

For front yards, always face grain direction toward the street for best curb appeal.

Mistakes can cost money.

This is the start to a detailed, but simple instructional guide to correctly installing SYNLawn®. Be sure to carefully survey the area and begin measuring always keeping the grain direction of the artificial grass the same. Face it toward the direction it will be seen most.

- ▶ **Measure the job carefully.** If you have many curves and irregular shapes, we recommend adding 10-20% more artificial grass than your area's actual square footage. When designing, try to install the artificial grass in 15' wide sections. **SYNLawn Artificial Grass** is sold in 15' widths (example 15' x 20'). Use graph paper, a **sketchpad or iPad** to record all measurements and note grain direction.
- ▶ We suggest you measure as close to exact numbers as possible rather than estimating by total square footage.

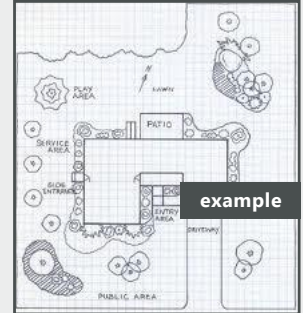

In high traffic paths, we recommend installing a pathway of stepping stone or pavers. This will help prevent the artificial grass from matting down and the need for more frequent maintenance.

Calculations (measure in 15' wide sections when possible)

Area 1

length (at longest point) x width = _____

Area 2 & 3: length x width = _____

Area 1+Area 2+ Area 3 = _____ total sq.ft.

Total sq.ft. / 15 = _____ total linear feet needed

Order artificial grass as 15' x _____ (total linear feet calculated)



lowes.synlawn.com

866-268-6100

service@synlawn.com

#45036

Project Checklist

- ✓ Base material
- ✓ Double checked measurements for accuracy to ensure no material shortages
- ✓ **SYNLawn Artificial Grass**
- ✓ Accessories

SYNLawn Infill #4663463

SYNLawn Adhesive #4663465 (if seams are needed)

SYNLawn Seam Cloth #1137836 (if seams are needed)

SYNLawn Landscape Nails #5228291

SYNLawn Weed Barrier #4663466

SYNLawn Rake #4663464

Irrigation items (if needed)

- ✓ Have all required tools (below is a list of tools you may or may not need, depending on the size of the project)

Measuring Wheel

Tape Measure

Marking Paint

Sketchpad or iPad

Sod Cutter

Flat Shovel

Hand Tamp

Vibratory Plate Compactor

Grading Rake

Wheelbarrow

Carpet Knife

Loop File Cutter

Trowel

Power Broom

Drop Seed Spreader

Leaf Blower

Hammer

Water Hose

- ✓ Care & Maintenance Instructions
- ✓ Cleaned area of all debris



lowes.synlawn.com

866-268-6100

service@synlawn.com

#45036

Accessory Ratios



SYNLawn Weed Barrier

Covers up to 150 sq.ft.



SYNLawn Seam Cloth

Seams up to 20 ft.



SYNLawn Adhesive

Covers up to 7 ft.



SYNLawn Landscape Nails

Needed for edges and seams every 8" to 12"



SYNLawn Infill

1 ½ - 2 ½ lbs. needed per sq.ft.



SYNLawn Soft Surface Spot Sanitizer

Treats up to 2,000 sq.ft.



SYNLawn Pet Odor Neutralizer

Treats up to 2,000 sq.ft.

Estimating Materials

The drawing to the right indicates a sketch for a typical yard. In this case, there is areas with mulch and shrubs (all four corners) that will not require artificial grass. As you can see, there is a 15' x 44' area, a 10' x 30' area, and a 4' x 9' area. This project would require seams, indicated by the dashed line between the sections.

NOTE

- Always measure to the longest point.
- You will need about 1 ton of aggregate or base material for every 100 sq.ft. at a 3" depth. This project would require approximately 10 tons of aggregate. For each ton of aggregate, you will need approximately 13-16 **wheelbarrows** full that will need to be hauled to the project area from the staged dumping site.
- If artificial grass is being installed over concrete, a glue-down method may be used and no base is required.

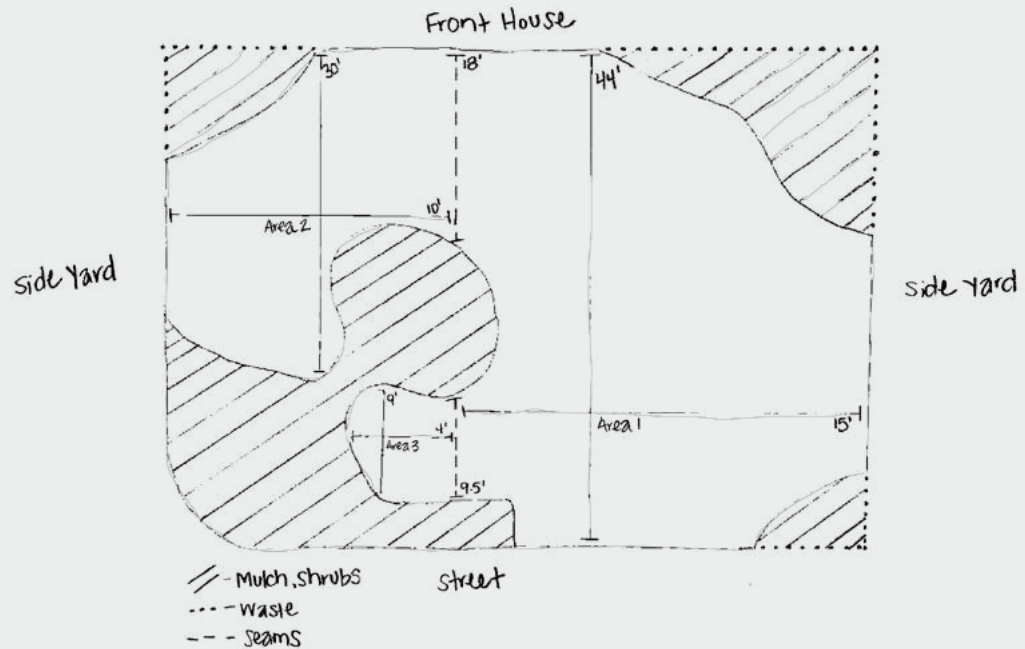

To estimate SYNLawn Artificial Grass needed

Area 1

15' x 44' = 660 sq.ft. It is encouraged to purchase 10-20% extra to account for curves and errors. You will need a 15' x 49' piece of artificial grass accounting for extra.

Area 2

10' x 30' = 300 sq.ft. You will need a 15' x 33' piece of artificial grass accounting for extra. Note for Area 2: Even though this area is only 10' wide, you must purchase in 15' widths. You will have 5' x 33' piece of artificial grass leftover to use for Area 3.

Area 3

4' x 9' = 36 sq.ft. You will need the leftover piece from Area 2: 5' x 33' with artificial grass waste leftover. No additional artificial grass purchase necessary to install Area 3.

Total artificial grass needed

15' x 49' + 15' x 33' = 15' x 82' or 1230 sq.ft. of artificial grass.

To estimate base material

Figure out the total square feet for the area requiring artificial grass.

Area 1: 660 sq.ft. + Area 2: 300 sq.ft. = 960 sq.ft.

(Area 3 is not needed in calculation as it is smaller than the mulch/shrub area in Area 2)

Total sq.ft. / 100 = # of tons of aggregate at 3" depth

To estimate other materials

SYNLawn Seam Cloth | Measure full length of area to be seamed. Each roll covers 20 ft. (Drawing shows 27.5' of seaming, about 2 rolls needed).

SYNLawn Adhesive | Measure full length of area to be seamed. Each tube covers up to 7 ft. on seam cloth (about 4 tubes needed).

SYNLawn Weed Barrier | Measure full length of area to be installed. Each roll covers up to 150 sq.ft. (about 7 rolls needed).

SYNLawn Landscape Nails | Measure full length of edges and seams to be installed. A nail is required every 8"-12" (about 2 bags needed).



lowes.synlawn.com

866-268-6100

service@synlawn.com

#45036

Site Preparation



Tools & Materials

Sod Cutter

Flat Shovel

NOTE

Don't forget to run drip lines to trees or plants that were receiving water from this source.

- ▶ Treat any weed or rodent problem prior to the installation. Gopher wire (hardware cloth) can be installed under the artificial grass's base. **SYNLawn Weed Barrier** can also be used to help prevent further growth.
- ▶ Determine the proper amount of base material (decomposed granite or recommended base material for your area).
- ▶ Remove the grass, dirt, rock or whatever is in the area the **SYNLawn Artificial Grass** will be installed. Depending on your area, remove between 3"- 4" to create an adequate drainage base.
- ▶ Use a **sod cutter** or **flat shovel** and haul away material.
- ▶ Grade sub grade level and compact if needed.
- ▶ If there is no grass and the yard consists of dirt, pay close attention to the depth in all areas to determine the amount of base material needed.
- ▶ Have the project site's water turned off a few days before starting the **SYNLawn Artificial Grass** installation.
- ▶ Be sure all of the project site's sprinklers are removed and capped off or cut the irrigation valves.



<https://youtu.be/OX4EmkrOVa4> watch the Base Preparation video!

Calculations (measure in 15' wide sections when possible)

(3" in depth – Total sq.ft. of area) / 100 = _____

(4" in depth – Total sq.ft. of area) / 80 = _____

This calculation will provide you with the total TONS of base material needed.



lowes.synlawn.com

866-268-6100

service@synlawn.com

#45036

Installing The Base



Tools & Materials

Hand Tamp
Vibratory Plate Compactor
Grading Rake
Wheelbarrow
Base Material
Water Hose

SYNLawn Weed Barrier

NOTE

When installing next to a concrete slab or walkway the compacted base should be 1" to 1.5" below the surrounding grade level.

- ▶ Rock yards use different materials to create Road Base. Please inquire with your SYNLawn dealer or local rock company to determine the best option for your area and which product is best suited for your compacted drainage bed.
- ▶ Install **SYNLawn Weed Barrier** on top of prepared sub grade if needed for tough weed problems.
- ▶ Haul base material from street using **wheelbarrows** and dump in desired area until you create a 3" - 4" base.
- ▶ Using a **grading rake**, prepare the base level for proper drainage.
- ▶ Use a **water hose** to water down graded base area to help with base compaction.
- ▶ Use a **vibratory compactor** to compact base until you reach an 80% compaction rate. A **hand tamper** should be used to reach small or tight areas. Improper or incomplete compaction could result in improper drainage. Repeat as needed to acquire desired base.
- ▶ If you need a small amount of fines, DG (decomposed granite) or stone dust can be used to fill in any large pits in the compacted base.
- ▶ All great lawns have a solid base, be sure to go over the area several times and remove any large rocks or objects from the soil.





lowes.synlawn.com

866-268-6100

service@synlawn.com

#45036

Special Considerations



PET PROJECTS

When installing artificial grass in pet areas, take special precautions in regard to odors. It is highly recommended to use zeolite product for this purpose. Depending on which brand of products you are using, follow the recommended guidelines for installation. Some products need to be applied on top of the base, others are better as infill, and sometimes it is suggested to do both. It is also recommended to use nails every 4" – 6" instead of 8" – 12" apart on all pet projects. Installing a perimeter board around the area to secure the artificial grass is ideal, but not required. Pet projects will require additional maintenance. Be sure to read our Care & Maintenance Instructions.

PLAYGROUND PROJECTS

Fall zones under playground equipment using an underlayment foam pad can be created for your playground projects. Installation training can also be available as there are many important things to know when installing the additional materials needed such as increasing the grade and underlayment foam products.

PUTTING GREEN

Putting green installations require special instructions for a quality putting green. Training can be available for the proper procedures, as well as, ensuring you know which products and accessories are best suited for your project.



lowes.synlawn.com

866-268-6100

service@synlawn.com

#45036

Artificial Grass Installation



Tools & Materials

Carpet Knife

Loop Pile Cutter

Hammer

SYNLawn Artificial Grass

SYNLawn Landscape Nails

NOTE

Before laying the artificial grass, be sure the grain direction aligns with the original design.

- ▶ Unroll and cut artificial grass in the driveway or large open area away from installation site. Slightly overmeasure being cautious to not cut too short.
- ▶ If artificial grass is being installed over concrete, a glue-down method may be used and no base is required.
- ▶ Place cut artificial grass on the completed base in install location before you make any other cuts.
- ▶ The final detail cuts are made after artificial grass is nailed in place. Always cut artificial grass from the back side.
- ▶ Using **SYNLawn Landscape Nails**, nail one end of the artificial grass section, tightly pulling other end in place. If artificial grass section is large, you can kick the artificial grass forward using your feet, this helps tighten the artificial grass into place. Nail the other end into base. All artificial grass edges should be secured with nails every 8" to 12", nailing through the artificial grass and into the base. Be careful not to crimp the artificial grass fibers under the nail heads.
- ▶ Perform final detail cuts and nail into base.





lowes.synlawn.com

866-268-6100

service@synlawn.com

#45036

Artificial Grass Seaming



Tools & Materials

Trowel

SYNLawn Seam Cloth

SYNLawn Adhesive

SYNLawn Landscape Nails

NOTE

Be sure to smooth out the rolls of artificial grass before seaming.

- ▶ With the **SYNLawn Artificial Grass** sections side by side, make sure all of the rows are aligned in the same direction.
- ▶ Try to maintain equal spacing between the fiber rows.
- ▶ Nail each side of the artificial grass into the base, staggering the **SYNLawn Landscape Nails** every 8"- 12" apart.
- ▶ Use **SYNLawn Seam Cloth** to connect the artificial grass sections together. Use **SYNLawn Adhesive** and spread with a **trowel** onto the **SYNLawn Seam Cloth** and carefully lay the artificial grass over onto the **SYNLawn Seam Cloth**. The seam will need time to dry or cure based on recommended curing times located on the adhesive label. Adding weight like bags of sand on the seams helps create a better bond.
- ▶ Take your time on the seams. The more time and attention you give to details on the seams, the better they will turn out.



<https://youtu.be/iIVslCH07W8> watch the Artificial Grass Prep & Seaming video!





lowes.synlawn.com

866-268-6100

service@synlawn.com

#45036

Final Steps



Tools & Materials

Power Broom

Drop Seed Spreader

Water Hose

SYNLawn Rake

SYNLawn Infill

NOTE

Be sure your levels of sand are consistent throughout.

- ▶ After your **SYNLawn Artificial Grass** is installed and secured to the base, we recommend adding a layer of **SYNLawn Infill** onto the artificial grass fibers. Use a **drop seed spreader** to evenly disperse sand. Be sure to use a **power broom** or **SYNLawn Rake** to disperse the sand into the artificial grass so it migrates to the primary backing. We recommend about 1 ½ - 2 ½ lbs. of sand per sq.ft., depending on the application and the product. The sand acts as ballast and helps protect from UV rays.
- ▶ With each layer of sand, the artificial grass needs to be vigorously brushed using a **power broom** or **SYNLawn Rake**. The sand will help support the fibers to stand upright. The artificial grass should be brushed across the fibers.
- ▶ The artificial grass seams should be cross-brushed in both directions. This will make the seams less visible.
- ▶ After installation is complete, the entire area needs to be cleaned. All excess sand or debris should be removed and hauled away. Artificial grass and surrounding concrete should be sprayed down with **water hose**. Your **SYNLawn Artificial Grass** is ready to enjoy!



<https://youtu.be/e6MEaklg47g> watch the Trim & Secure video!





lowes.synlawn.com

866-268-6100

service@synlawn.com

#45036